

# FireBox L

## Boîtes de dérivation L - Maintien de fonction

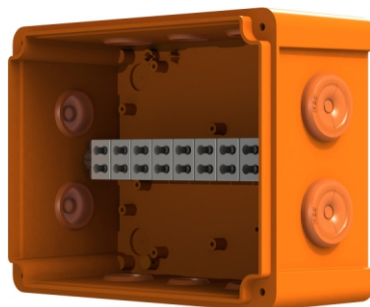

Bornier horizontal

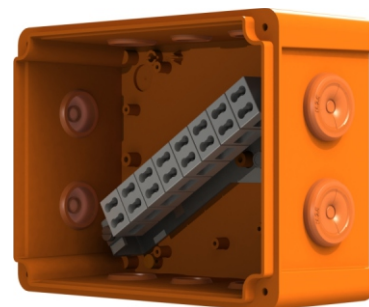

Bornier oblique

Porte-fusible - câblé en 2,5mm<sup>2</sup>  
SF0520-FB (accessoires FireBox)

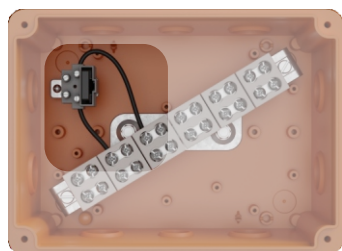

Pour  
micro-fusible  
5x20 mm



Set de 2 vis d'ancrage - Béton  
S2VAB-FB (accessoires FireBox)

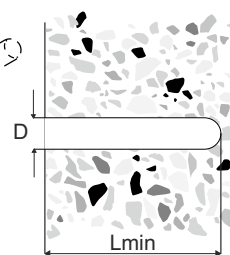
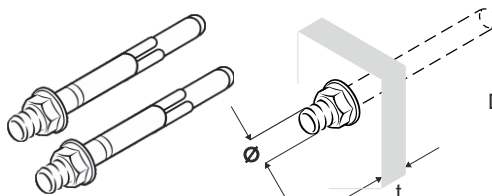

Dimensions (mm)

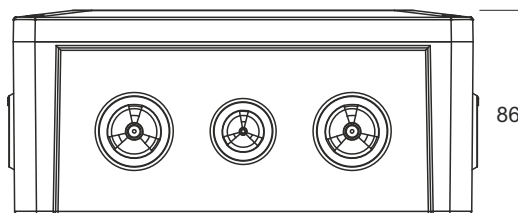
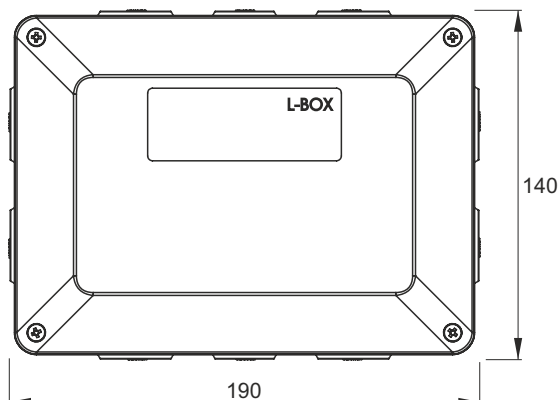

S2VAB-FB  
Lmin : 40 mm  
t : 0-30 mm  
Ø : 6 mm  
D : 6 mm

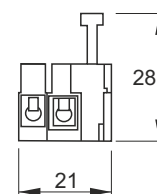
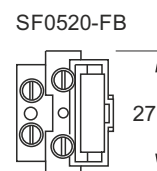
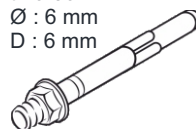

# FireBox L

## Boîtes de dérivation L - Maintien de fonction



### Données techniques

#### Générales

Matière	Polycarbonate sans halogène
Entrées de câbles	2x M20 et 8x M25
Environnement	-25 °C à 55 °C
Normalisation	DIN 4102-12
Nr de certification	063-UWB-0306 by CNBOP-PIB-KOT-2020/0229-3704 1 <sup>re</sup> édition of 30.10.2020

### Articles

	Type	N° article	Description	Maintien de fonction
	FSB012	2106 5012	6 pôles de 4 connecteurs 10 mm <sup>2</sup>	E90
	FSB015	2106 5015	5 pôles de 4 connecteurs 16 mm <sup>2</sup>	E90
	FSB020	2106 5020	12 pôles de 2 connecteurs 4 mm <sup>2</sup>	E60
	FSB022	2106 5022	7 pôles de 2 connecteurs 10 mm <sup>2</sup>	E90

FSB012

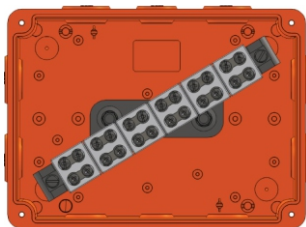

FSB015

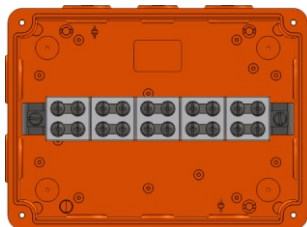

FSB020

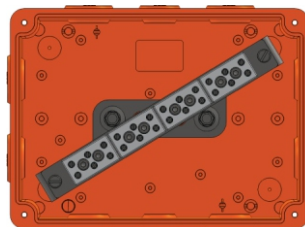

FSB022

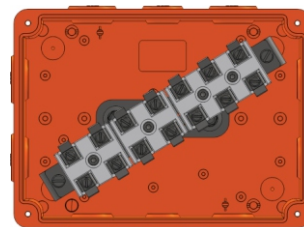

### Accessoires

#### Set de 2 vis d'ancrage

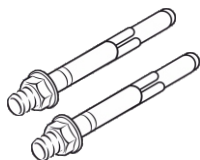

Type	N° article	Description
S2VAB-FB	2106 5050	Pour un montage vertical ou horizontal sur une surface de support en béton ou en pierre
Lmin : 40 mm	(profondeur minimum d'insertion)	
t : 0-30 mm	(largeur de l'élément à fixer)	
D : 6 mm	(diamètre du trou)	
Ø : 6 mm	(diamètre de la vis)	

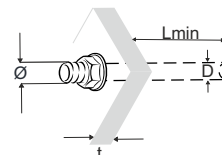

#### Porte-fusible



Type	N° article	Description
PF0520-FB	2106 5060	Pour la protection d'un circuit secondaire qui se situe dans un autre compartiment coupe-feu
Pour micro-fusible 5x20 mm (0,5, 1, 2,5, 3,15 A) câblé en 2,5mm <sup>2</sup>		

